



rise  
CONSTRUCTION FRAMEWORK

# Buyers Guide

2022-2026

Bold – Ethical – Transparent – Expert - Champion

# Contents

Changing Lives With Rise Construction Framework	3
Our Brand Values	4
Value for Members	5
Meet the Team	6
What We Do	7
Why Choose Us	12
Membership	13
Appointing a Supply Partner	14
Framework Groups	15
Supply Partners	16
Contact	42



# Changing lives with Rise Construction Framework

A social business, Rise is a multi-award-winning construction framework that exists to provide social benefits to communities by investing monies into the VCSE sector to fund much needed community intervention and prevention services.

Prior to founding Rise Construction Framework our Director, Sara, worked in the public sector for 27yrs devising and delivering frontline public sector services to help communities become safer, stronger, healthier and economically active - these are the foundations upon which Rise was built.

Combining her understanding of poverty and its effects on communities Sara created an organisation with purpose that exists to provide social benefits to communities.

Underpinning our social mission is a dynamic, efficient, free to join, PCR compliant one stop shop for capital works and services.

With 100 reputable Supply Partners spanning across 17 groups Rise is the most comprehensive framework on the market.

Our supply partners have successfully delivered a wide range of capital projects across NHS Trusts, Education Providers, Housing Providers and Local Authorities.

“Comparing Rise to other frameworks is like comparing apples to oranges because Rise was born from a place of purpose not profit”

**Sara Lawton, Director**

Rise has 100 reputable Supply Partners and has been accessed over **500** times by public sector partners.

Rise can be accessed from  
**25.03.2022 - 24.03.2026**

# Rise Brand Values



## **Bold**

“Walk towards the mess”  
addressing societies most  
challenging problems.



## **Championing**

Crusading to make the  
difference everyday.



## **Expert**

Industry and  
Community experts we  
use our business for  
good



## **Transformative**

Bringing an ethical and  
transparent way of doing  
business to others.



## **Ethical**

We are obsessed with  
doing things the right way,  
no shortcuts.

# Value For Members

- Not funded by the construction industry we always work in the interests of our public-sector partners.
- Our community investment strategy drives innovative social impact across communities
- Directly funding the VCSE sector, Rise makes public-sector money work harder whilst relieving the pressure on public-sector services
- Rise is financially transparent
- Helping our SME's supply partners sustain creates employment opportunities helping to grow the local economy
- If you procure construction services, our consultancy services are free of charge.
- Fees are negotiated for public-sector partners wanting to work with Rise long-term.

# Meet team Rise!



**Sara Lawton**  
Managing Director



**Vince & Mary**  
Business Development



**Daniel Ross**  
Framework Manager



**Elliot Hassan**  
Framework Administrator



**Lucy Gosling**  
Apprentice Office Administrator



**Social Impact**

# Thrive Careers Hub

Thrive is a dedicated safe space for support workers and young people to meet, build relationships and access job search support. Thrive's purpose is to support socially excluded young people who are furthest away from the job market, many of whom have already encountered significant challenges during their lives.

Thrive was founded by Rise in 2020 as our first in house social initiative, in its first year Thrive directly benefitted over **400 young people**, creating **£1.1m** of Social Impact, achieving a **£9.51** Social Return On Investment.

Rise's investment into Thrive is not only financial, with the whole Rise team offering time and resources to ensure Thrive is fully supported.



Since inception:

- **343** visits by support workers
- **1326** visits by young people
- **77** young people into work



# Blackpool Carers- Adult Respite Support

Rise community funding awarded to **Blackpool Carers Centre** enabled the centre to continue to employ an Adult Respite Support Worker to extend the scope of adult carer respite provided over a 6 month period. The centre delivered a mixture of activities some of which were delivered in the centre gardens including art, music, dance and yoga. Adult carers were also given the opportunity to attend a number of external trips.



- **75 individuals benefitted**
- **89 sessions delivered**
- **3 external trips**



*"If it wasn't for the centre, I don't know what I'd do. Last week I could hardly get out of bed for fear of what the day held and was going to bed early exhausted. Just taking that bit of time out for myself has made me feel so much better and able to take on the day knowing that the sessions will be there every week or that I can go and sit in the garden or potter whenever I need to."*

**Heather, Adult Carer**

# Specialist Creche Worker

Rise awarded **SafeNet** community funding monies to cover the cost of employing a Specialist Crèche Worker for 12 months. The DA trained creche worker responds to all behaviours children may display that are associated with living in an abusive household. She works alongside SafeNet's children and young people worker supporting children on a 1-2-1 basis aiding their development and growth. In addition to supporting the children the role allows mothers to attend workshops to help them live independently, free from abuse.

*"I can't put it into words, this is the safest place I've ever been in since coming to the UK. Before I came to refuge I thought there were only bad people left in this world...It's completely changed my mind set and I know there are good people. I am very happy here and I will never forget this. I could never thank you enough"*

*"I had no money to live on. I had no immigration status. I was unable to get medical care. I was homeless. Coming to this service helped me in every way and I am thankful for it"*

- **66 Adults and 139 Children accessed support**
- **100% of parents felt their parenting skills had improved and that they understand more about the impact of domestic abuse on their children.**



**Making public money work harder by funding projects that support local communities.**



# Why Choose Rise?

- ✓ We make public money work harder by funding projects that support local communities
- ✓ We deliver faster through our 24-hour direct appointment process.
- ✓ We deliver more value for your money through our wide range of vetted and prequalified SME supplier partners.
- ✓ We have a proven track record of driving social impact across communities by tackling issues such as domestic violence, homelessness, isolation, youth unemployment and well-being
- ✓ We are a fully compliant, ethical and transparent; you can rest assured there will be no surprises when working with us.
- ✓ We have an extensive breadth of service areas; we can administer projects ranging from £0k to £15m+ in the Northwest, North Wales, Yorkshire and Humberside.
- ✓ We are experts in communities and our industry and take our work seriously; meaning we always go the extra mile.
- ✓ By working with us, you are transforming communities with social value led procurement



# Membership



Public-sector organisations can access the framework by becoming a Rise member.

We have made our systems user friendly to ensure you receive an efficient service that does not burden you or your teams with over complicated paperwork or processes.

Members of the framework can directly appoint supply partners or enter into further mini competition.

As a team, we are readily available to meet with members and potential members to discuss how we can support you and your capital projects.

To obtain a membership form, **email: [info@rise-framework.com](mailto:info@rise-framework.com)**

Membership to the framework for public-sector organisations is **free!**

# Appointing a Supply Partner

Our clients can award contracts in **two** ways

## Direct Appointment

Eligible when project value is below PCR thresholds (inclusive of VAT as per PPN 10/21).

**£213,477**

Services (Consultants)

**£5,336,937**

Works (Contractors)

## Mini-competition

All projects above PCR thresholds are subject to further mini-competition.

# Framework Groups



- **House Building**
- **General Construction**
- **Refurbishment**
- **Modular Build**
- **Civil Engineering & Highways**
- **M&E Contractor**
- **Facilities Maintenance**
- **Safety & Compliance Works**

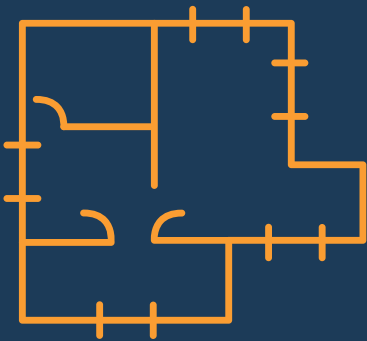

- **Architectural Services**
- **Project Management JCT & NEC**
- **Cost Management JCT & NEC**
- **Contract Administrator**
- **Employers Agent**
- **MEP Services**
- **Structural & Civil Engineering Services**
- **Safety & Compliance Services**
- **Clerk of Works**



Group 1

## House Building

- Band 1 £0k – £50k
- Band 2 £50k – £1m
- Band 3 £1m – £5m
- Band 4 £5m – 15m
- Band 5 £15m+

### Band 1: £0-50k

GK Construction and Project Management

### Band 2: £50k-1m

GK Construction and Project Management

John Turner Construction

PLP Construction

### Band 3: £1m-5m

EQUANS

Housing Maintenance Solutions

J Greenwood Builders

John Turner Construction

M&Y Maintenance & Construction

PLP Construction





Group 1

## House Building

- Band 1 £0k – £50k
- Band 2 £50k – £1m
- Band 3 £1m – £5m
- Band 4 £5m – 15m
- Band 5 £15m+

### Band 4: £5m-15m

EQUANS

Eric Wright Construction

John Turner Construction

M&Y Maintenance & Construction

### Band 5: £15m+

EQUANS

Eric Wright Construction



## Group 2

### General Construction

Band 1 £0k – £50k

Band 2 £50k – £1m

Band 3 £1m – £5m

Band 4 £5m – 15m

Band 5 £15m+

### Band 1: £0-50k

ALM Construction

Avrenim Group

D&G Builders and Joiners

Greenmount Projects

IED Installations

Jamieson Contracting NW

Manchester & Cheshire Construction

Novus Property Solutions

RECOM Solutions

Skyline Property Solutions

Sterling

Truline Construction & Interior Service

Warden Construction

### Band 2: £50k-1m

ALM Constuction

Avrenim Group

City Build Manchester

D&G Builders and Joiners

Greenmount Projects

Hightown Construction

Housing Maintenance Solutions

J Greenwood Builders

Jamieson Contracting NW

John Turner Construction

Krol Corlett

Manchester & Cheshire Construction

Novus Property Solutions

PLP Construction

Rosslee Construction

RECOM Solutions

Sterling

Truline Construction & Interior Service

Walter Carefoot & Sons

Warden Construction



## Group 2

### General Construction

Band 1 £0k – £50k

Band 2 £50k – £1m

Band 3 £1m – £5m

Band 4 £5m – 15m

Band 5 £15m+

### Band 3: £1m-5m

Avrenim Group

City Build Manchester

D&G Builders and Joiners

EQUANS

Eric Wright Construction

F Parkinson

Greenmount Projects

Housing Maintenance Solutions

John Turner Construction

Krol Corlett

M&Y Maintenance & Construction

Novus Property Solutions

PLP Construction

Read Construction

RECOM Solutions

Robertson Construction

Seddon

Sterling

Walter Carefoot & Sons

Warden Construction

### Band 4: £5m-15m

Conlon Construction

EQUANS

Eric Wright Construction

John Turner Construction

M&Y Maintenance & Construction

Morgan Sindall

Read Construction

Robertson Construction

Seddon

Walter Carefoot & Sons



Group 2

## General Construction

Band 1 £0k – £50k

Band 2 £50k – £1m

Band 3 £1m – £5m

Band 4 £5m – 15m

Band 5 £15m+

## Band 5: £15m+

EQUANS

Eric Wright Construction

Galliford Try Construction

Morgan Sindall

Robertson Construction

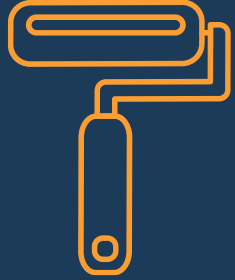

### Group 3

## Refurbishment

- Band 1 £0k – £50k
- Band 2 £50k – £1m
- Band 3 £1m – £5m
- Band 4 £5m – 15m
- Band 5 £15m+

### Band 1: £0-50k

ALM Construction Ltd  
Ashton Joinery & Builders  
Avrenim Group  
D&G Builders and Joiners  
Greenmount Projects  
IED Installations  
Jamieson Contracting NW  
Jennor UK  
Manchester & Cheshire Construction  
Novus Property Solutions  
RECOM Solutions  
Skyline  
Sterling  
Truline Construction & Interior Service  
Warden Construction

### Band 2: £50k-1m

ADT Workplace  
ALM Construction  
Ashton Joinery & Builders  
Avrenim Group  
City Build Manchester  
D&G Builders and Joiners  
Housing Maintenance Solutions  
J Greenwood Builders  
John Turner Construction  
Krol Corlett  
M&Y Maintenance & Construction  
Novus Property Solutions  
PLP Construction  
Rosslee Construction  
RECOM Solutions  
Seddon  
Sterling  
Truline Construction & Interior Service  
Walter Carefoot & Sons  
Warden Construction

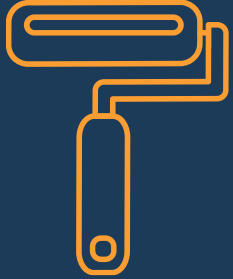

### Group 3

## Refurbishment

- Band 1 £0k – £50k
- Band 2 £50k – £1m
- Band 3 £1m – £5m
- Band 4 £5m – 15m
- Band 5 £15m+

### Band 3: £1m-5m

- Avrenim Group
- Casey
- City Build Manchester
- EQUANS
- Eric Wright Construction
- F Parkinson
- Greenmount Projects
- Housing Maintenance Solutions
- John Turner Construction
- Krol Corlett
- M&Y Maintenance & Construction
- Novus Property Solutions
- Read Construction
- RECOM Solutions
- Robertson Construction
- Seddon
- Sterling
- Truline Construction & Interior Service
- Walter Carefoot & Sons
- Warden Construction

### Band 4: £5m-15m

- ADT Workplace
- Conlon Construction
- EQUANS
- Eric Wright Construction
- John Turner Construction
- M&Y Maintenance & Construction
- Morgan Sindall
- Robertson Construction
- Seddon
- Walter Carefoot & Sons

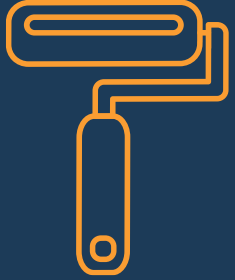

Group 3

## Refurbishment

- Band 1 £0k – £50k
- Band 2 £50k – £1m
- Band 3 £1m – £5m
- Band 4 £5m – 15m
- Band 5 £15m+

## Band 5: £15m+

EQUANS

Eric Wright Construction

Morgan Sindall

Robertson Construction



Group 4

## Modular Build

Band 1 £0k – £50k

Band 2 £50k – £1m

Band 3 £1m – £5m

Band 4 £5m – 15m

### Band 1: £0-50k

D&G Builders and Joiners

Seddon

### Band 2: £50k-1m

Seddon

Select Plant Hire

### Band 3: £1m-5m

Select Plant Hire

### Band 4: £5m-15m

Select Plant Hire





## Group 5

### Civil Engineering & Highways

Band 1 £0k – £50k

Band 2 £50k – £1m

Band 3 £1m – £5m

Band 4 £5m – 15m

Band 5 £15m+

#### Band 1: £0-50k

D&G Builders and Joiners

George Cox & Sons

Jamieson Contracting NW

Novus Property Solutions

Sterling

#### Band 3: £1m-5m

Casey

Eric Wright Civil Engineering

Galliford Try Construction

George Cox & Sons

Jamieson Contracting NW

Keltbray Highways

Sterling

#### Band 2: £50k-1m

Eric Wright Civil Engineering

George Cox & Sons

Jamieson Contracting NW

PLP Construction

Sterling



Group 5

## Civil Engineering & Highways

Band 1 £0k – £50k

Band 2 £50k – £1m

Band 3 £1m – £5m

Band 4 £5m – 15m

Band 5 £15m+

### Band 4: £5m-15m

Eric Wright Civil Engineering

Galliford Try Construction

Keltbray Highways

Lagan Aviation and Infrastructure

### Band 5: £15m+

Galliford Try Construction

Keltbray Highways



Group 6

## M&E Contractor

Band 1 £0k – £50k

Band 2 £50k – £3m

### Band 1: £0-50k

A Copeland Group  
Consortia Integrated Services  
CPL Heating & Plumbing  
EE Thompson & Son  
HE Simm Maintenance Services  
JD Engineering  
Kimpton Energy Solutions  
Novus Property Solutions  
Performance Electrical  
Seddon  
Senate Mech  
Sterling  
The James Mercer Group  
W H Good

### Band 2: £50k-3m

A Copeland Group  
Consortia Integrated Services  
CPL Heating & Plumbing  
EE Thompson & Son  
IED Installations  
JD Engineering  
Kimpton Energy Solutions  
M&Y Maintenance & Construction  
Performance Electrical  
Seddon  
Senate Mech  
Sterling  
The James Mercer Group  
W H Good

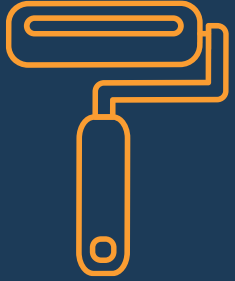

Group 7

**Facilities**

**Maintenance**

Band 1 £0k – £50k

Band 2 £50k – £3m

### **Band 1: £0-50k**

Avrenim Group

Consortia Integrated Services

EE Thompson & Son

M&Y Maintenance & Construction

Novus Property Solutions

### **Band 2: £50k-3m**

Avrenim Group

City Build Manchester

Consortia Integrated Services

EE Thompson & Son

Novus Property Solutions



Group 8

**Safety &**

**Compliance Works**

Band 1 £0k – £50k

Band 2 £50k – £1m

Band 3 £1m – £5m

Band 4 £5m – 15m

Band 5 £15m+

### Band 1: £0-50k

Fieldway Supplies

Novus Property Solutions

RECOM Solutions

Skyline Property Solutions

Tailored Fire & Security Group

### Band 2: £50k-1m

Fieldway Supplies

M&Y Maintenance & Construction

Novus Property Solutions

RECOM Solutions

Skyline Property Solutions



Group 8

**Safety &**

**Compliance Works**

Band 1 £0k – £50k

Band 2 £50k – £1m

Band 3 £1m – £5m

Band 4 £5m – 15m

Band 5 £15m+

### **Band 4: £5m-15m**

EQUANS

M&Y Maintenance & Construction

### **Band 5: £15m+**

EQUANS

### **Band 5: £15m+**

EQUANS

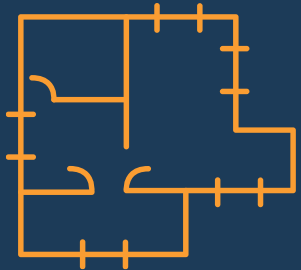

Group 9

## Architect

Band 1 £0k – £200k

Band 2 £200k+

### Band 1: £0-200k

10architect

ADP Architecture

AEW Architects

AHR Architects

David Miller Architects

Day Architectural

Ellis Williams Architects

Frank Whittle Partnership

Halsall Lloyd Partnership

K2 Architects

Mersey Design Group

Rider Levett Bucknall

Sir Robert McAlpine

Unit 3 Design Studio

Wilson Mason

### Band 2: £200k+

10architect

ADP Architecture

AHR Architects

David Miller Architects

Day Architectural

Ellis Williams Architects

K2 Architects

Mersey Design Group

Rider Levett Bucknall

Wilson Mason



Group 10

**Project**

**Management JCT**

Band 1 £0k – £200k

Band 2 £200k+

### Band 1: £0-200k

Day PM

Frank Whittle Partnership

Gosling Consulting

Hive Projects

RECOM Solutions Ltd

Rider Levett Bucknall

Walker Sime

### Band 2: £200k+

Day PM

Gosling Consulting

Hive Projects

RECOM Solutions Ltd

Rider Levett Bucknall

Walker Sime





Group 10.1

**Project**

**Management NEC**

Band 1 £0k – £200k

Band 2 £200k+

### **Band 1: £0-200k**

Day PM

Frank Whittle Partnership

Gosling Consulting

Hive Projects

Rider Levett Bucknall

### **Band 2: £200k+**

Day PM

Gosling Consulting

Hive Projects

Rider Levett Bucknall



Group 11

## Cost Management

JCT

Band 1 £0k – £200k

Band 2 £200k+

### Band 1: £0-200k

Brooke Cost Consulting

Day Cost Management

Frank Whittle Partnership

Gateley Vinden

Gosling Consulting

Hive Projects

O'Neil and Partners

Rider Levett Bucknall

Walker Sime

### Band 2: £200k+

Brooke Cost Consulting

Day Cost Management

Gateley Vinden

Gosling Consulting

Hive Projects

Rider Levett Bucknall

Walker Sime



Group 11.1

**Cost Management**  
**NEC**

Band 1 £0k – £200k

Band 2 £200k+

**Band 1: £0-200k**

Day Cost Management

Frank Whittle Partnership

Gateley Vinden

Gosling Consulting

Hive Projects

Rider Levett Bucknall

**Band 2: £200k+**

Day Cost Management

Gateley Vinden

Gosling Consulting

Hive Projects

Rider Levett Bucknall



Group 12

**Contract**

**Administrator**

Band 1 £0k – £200k

Band 2 £200k+

### **Band 1: £0-200k**

Actua Chartered Surveyors

Frank Whittle Partnerhsip

Gateley Vinden

Gosling Consulting

Hive Projects

JWA

Rider Levett Bucknall

Rowley Szilagy

Watts Group

### **Band 2: £200k+**

Actua Chartered Surveyors

Gateley Vinden

Gosling Consulting

Hive Projects

JWA

Rider Levett Bucknall

Rowley Szilagy

Watts Group



Group 13

## Employers Agent

Band 1 £0k – £200k

Band 2 £200k+

### Band 1: £0-200k

Frank Whittle Partnership

Gateley Vinden

Gosling Consulting

Hive Projects

Rider Levett Bucknall

Walker Sime

Watts Group Ltd

### Band 2: £200k+

Gateley Vinden

Gosling Consulting

Hive Projects

Rider Levett Bucknall

Walker Sime

Watts Group Ltd



Group 14

## MEP Services

Band 1 £0k – £200k

Band 2 £200k+

### Band 1: £0-200k

AP Bellis & Associates

Beech Jackson Partnership

Clancy Consulting

Crookes Water Consulting

Cundall Johnson & Partners

Frank Whittle Partnership

Furureserv

NECO Services Design Ltd

Pettit Singleton Associates

S I Sealy Associates

Steven Hunt Associates

TACE

Viridian Consulting Engineers

### Band 2: £200k+

AP Bellis & Associates

Beech Jackson Partnership

Clancy Consulting

Crookes Water Consulting

Furtureserv

Pettit Singleton Associates

S I Sealy Associates

Steven Hunt Associates

TACE

Viridian Consulting Engineers

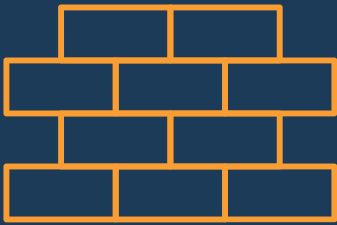

Group 15

**Structural & Civil  
Engineering  
Services**

Band 1 £0k – £200k

Band 2 £200k+

**Band 1: £0-200k**

Alan Johnson Partnership

Clancy Consulting

Cundall Johnson & Partners

Curtains Ltd

Frank Whittle Partnership

Sir Robert McAlpine

Sutcliffe

Waterman Structures Ltd

**Band 2: £200k+**

Alan Johnson Partnership

Clancy Consulting

Cundall Johnson & Partners

Curtains Ltd

Sir Robert McAlpine

Sutcliffe

Waterman Structures Ltd



Group 16

**Safety &  
Compliance  
Services**

Band 1 £0k – £200k

Band 2 £200k+

**Band 1: £0-200k**

Liberty Fire and Vision Ltd

Pettit Singleton Associates

Rider Levett Bucknall

**Band 2: £200k+**

Liberty Fire and Vision Ltd

Pettit Singleton Associates

Rider Levett Bucknall





Group 17

### Clerk of Works

Band 1 £0k – £200k

Band 2 £200k+

### Band 1: £0-200k

Actua Chartered Surveyors

Hickton Consultants

Pettit Singleton Associates

Rider Levett Bucknall

### Band 2: £200k+

Actua Chartered Surveyors

Hickton Consultants

Pettit Singleton Associates

Rider Levett Bucknall

# Contact



Rise Construction Framework  
Blackburne House  
Blackburne Place  
Liverpool  
L8 7PE



[info@rise-framework.com](mailto:info@rise-framework.com)



07463 540 183



[www.rise-framework.com](http://www.rise-framework.com)



[@riseframework](https://twitter.com/riseframework)



Rise Construction Framework